



**Cordless Jig Saw**  
**DJV184**



# Compact and Lightweight



Overall length

**259 mm**

Net weight

**2.4 kg**

Battery: BL1860B



### Cutting capacity

Wood  
**135 mm**

Aluminum  
**20 mm**

Steel  
**10 mm**





# SOFT NO LOAD

**Soft no-load speed mode**  
(with disabling function)  
Reduces vibration and aligns blade with the cutting line easily.

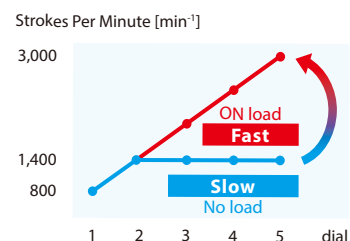

### Anti-malfunction switch



### Variable speed trigger switch



### For continuous operation



### Bevel range

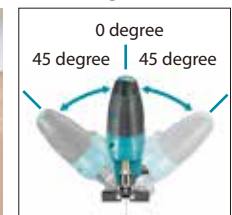

**BL MOTOR XPT**

**Work amount**  
on a single full battery charge

**Efficiency of wood cutting**  
about **165 cuts**

Battery: BL1860B  
Test material: MDF 24 x 300mm  
Max orbital action



### Orbital setting lever



3 Orbital settings + Straight cutting

### Variable speed control by dial



located on the rear side for easier operation

### Toolless blade clamp



with a blade holder which allows for one-hand blade change

## Accessories

**Dust nozzle**  
Part No. 413F05-1

**Dust cover**  
Part No. 458191-5

**Cover plate**  
Part No. 457867-1



**Anti-splitting device**  
Part No. 192557-6

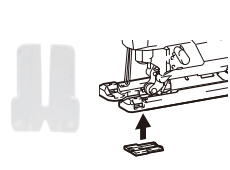

**Guide rail adapter set**  
Part No. 198704-7



**Guide rule set**  
Part No. 192732-4

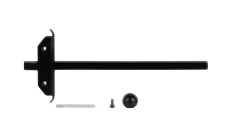

### Guide rail

Overall length	Part No.
1m	199140-0
1.4m	194368-5
1.5m	199141-8
1.9m	194925-9
3m	194367-7

## Charging Time

Battery	Fast Charging	
	DC18RC	DC18SD
BL1815N 1.5Ah	15 min	30 min
BL1820B 2.0Ah	24 min	45 min
BL1830B 3.0Ah	22 min	60 min
BL1840B 4.0Ah	36 min	90 min
BL1850B 5.0Ah	45 min	110 min
BL1860B 6.0Ah	55 min	130 min

## Cordless Jig Saw

DJV184	
Variable Speed	Capacity
Brake	Wood: 135 mm (5-5/16") Steel: 10 mm (3/8") Aluminum: 20 mm (25/32")
Constant Speed	Length of Stroke
Orbital Cutting	23 mm (7/8")
Bayonet Shank Jig Saw Blade	Strokes Per Minute (SPM)
Dust Collection	0 - 3,000
Built-in Job Light	Vibration Level
Carrying Case	Cutting Boards: 7.4 m/s <sup>2</sup> Cutting Sheet Metal: 5.1 m/s <sup>2</sup>
	Sound Pressure Level
	82 dB(A)
	Sound Power Level
	93 dB(A)
	Dimensions (L x W x H)
	259 x 77 x 205 mm (10-1/4 x 3 x 8-1/8")
	Net weight
	2.1 - 2.4 kg (4.6 - 5.3 lbs.)
	<b>Standard Equipment:</b> Jig Saw Blade, Hex Wrench, Cover Plate, Dust Nozzle (country-specific), Dust Cover (country-specific), Battery, Charger

The weight may differ depending on the attachment(s), including the battery cartridge. The lightest and heaviest combination, according to EPTA-Procedure 01/2014, are shown in the table. Items of standard equipment and specifications may vary by country or area.

**Makita Corporation**

3-11-8 Sumiyoshi-cho, Anjo, Aichi, 446-8502 Japan

PRINTED IN JAPAN 202202